

THIS DRAWING IS UNPUBLISHED. RELEASED FOR PUBLICATION
 © COPYRIGHT BY TYCO ELECTRONICS CORPORATION. ALL RIGHTS RESERVED.

LOC		DIST		REVISIONS			
AD	00	P	LTR	DESCRIPTION	DATE	DWN	APVD
		A		EC 0G3C-0303-04	14JUL04	BSV	MZ

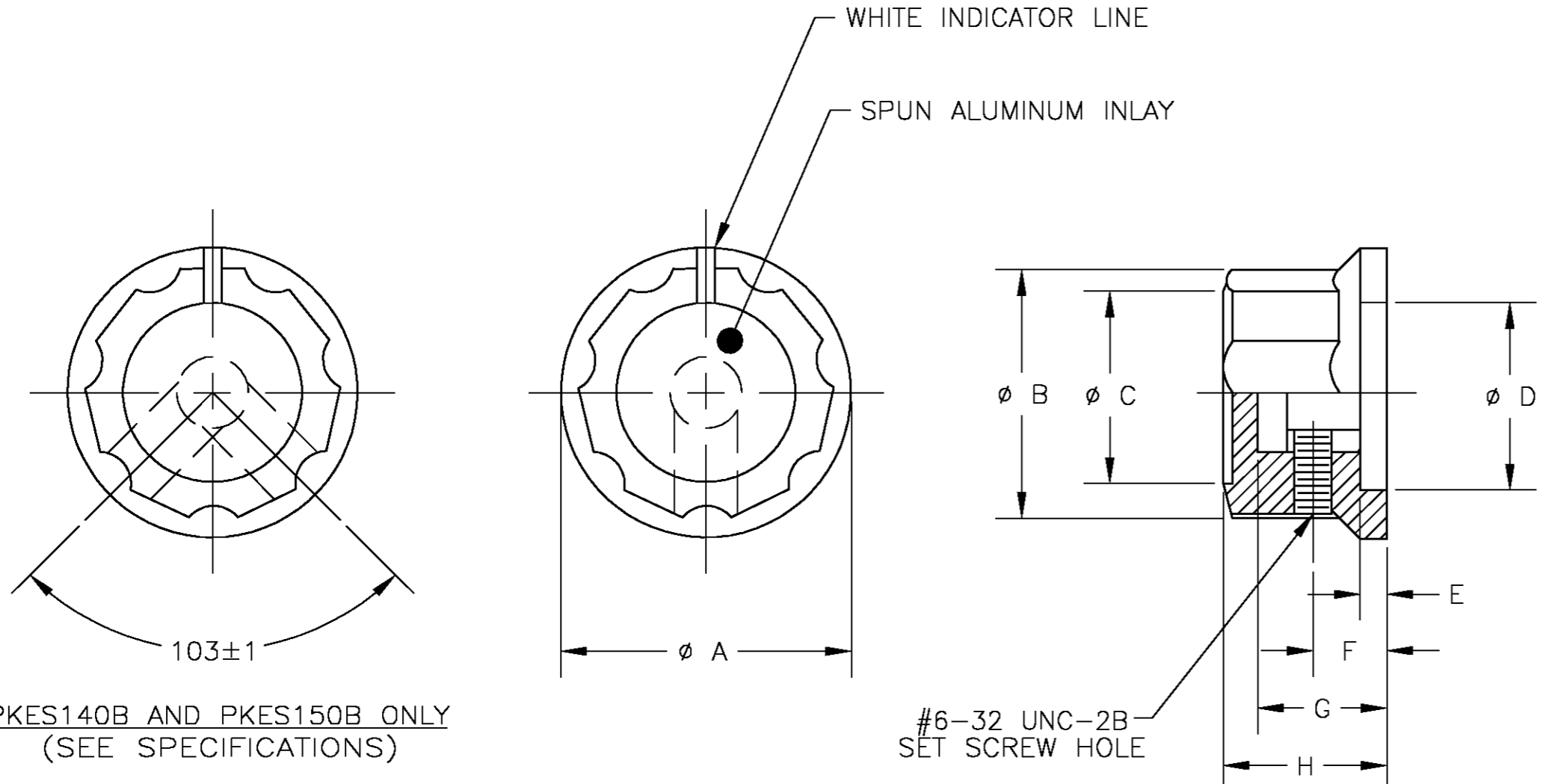

SPECIFICATIONS:

MATERIAL: PHENOLIC , COLOR: BLACK.
 SHAFT HOLE INSERT: COPPER ALLOY.
 SET SCREW: #6-32 UNC-2A
 PKES60B, PKES70B, PKES90B, AND PKES120B
 ONE SET SCREW ONLY.
 PKES140B AND PKES150B, TWO SET SCREWS ONLY.

NOTES:

1. INTERPRET DRAWING PER ASME Y14.5M-1994.
2. DECORATIVE SPUN ALUMINUM INLAY.
3. PLASTIC OVERLAY MUST BE PRESENT ON TOP SURFACE.
4. PACKAGING: FOR P/N PKES140B-1/4 & PKES120B-1/4, A CARDBOARD SHEET SHALL BE INSERTED BETWEEN THE OUTER SLEEVE & KNOB TRAY SO AS TO PREVENT THE KNOBS FROM FALLING OUT OF THEIR RESPECTIVE POCKETS.
5. VOID CORING FROM BOTTOM SIDE OF KNOB OPTIONAL.

PKES140B AND PKES150B ONLY
 (SEE SPECIFICATIONS)

5

TYCO P/N	MODEL	SHAFT HOLE ϕ	"A"	"B"	"C"	"D"	"E"	"F"	"G"	"H"
5-1437624-1	PKES60B1/8	.126	.748	.618	.400	.460	.090	.220	.370	.470
5-1437624-0	PKES60B1/4	.251	.748	.618	.400	.460	.090	.220	.370	.470
5-1437624-2	PKES70B1/4		.855	.744	.508	.705	.080	.275	.421	.526
5-1437624-3	PKES90B1/4		1.012	.889	.623	.846	.079	.256	.500	.570
4-1437624-6	PKES120B1/4		1.296	1.160	.858	1.018	.118	.320	.500	.628
4-1437624-7	PKES140B1/4		1.500	1.374	1.094	1.217	.118	.280	.540	.693
4-1437624-8	PKES150B1/4		1.768	1.551	1.217	1.413	.118	.300	.733	.831

	DIMENSION	TOLERANCE
SHAFT HOLE	.126 DIA.	+ .003 - .000
	.251 DIA.	+ .003 - .000

WAS DWG 80444

THIS DRAWING IS A CONTROLLED DOCUMENT.		DWN BSV	14JUL04	Tyco Electronics Corporation Harrisburg, Pa 17105-3808	
DIMENSIONS: INCHES		CHK -	APVD M ZITTO	NAME KNOB, FLUTED WITH SKIRT (PKES60, PKES70, PKES90, PKES120, PKES140 & PKES150)	
		TOLERANCES UNLESS OTHERWISE SPECIFIED: 0 PLC ± - 1 PLC ± - 2 PLC ± - 3 PLC ± .015 4 PLC ± - ANGLES ± 2° FINISH -		PRODUCT SPEC APPLICATION SPEC WEIGHT -	
MATERIAL SEE SPECIFICATIONS		CUSTOMER DRAWING		SCALE 1:1	RESTRICTED TO -
		SIZE A2	CAGE CODE 00779	DRAWING NO 4-1437624-6	REV A

4-1437624-6